



GREEN CHEM LABORATORIES

WARNING



Causes skin and eye irritation.

PRECAUTIONARY STATEMENT

If medical advice is needed, have product container or label at hand. Keep out of reach of children. Read label before use. Wash hands thoroughly after handling. Wear protective gloves and eye protection. **FIRST AID: IF ON SKIN:** Wash with plenty of soap and water. If skin irritation occurs: Get medical attention. Take off contaminated clothing and wash it before reuse. **IF IN EYES:** Rinse cautiously with water for several minutes. Remove contact lenses, if present and easy to do. Continue rinsing. If eye irritation persists: Get medical attention.

Read Safety Data Sheet before using.

KEEP OUT OF REACH OF CHILDREN.

Made in U.S.A. with globally sourced materials.

Product may not be compatible with some materials. Always test in an inconspicuous area prior to use.

INGREDIENTS Diethylene Glycol Monobutyl Ether (CAS#112-34-5), Ethylene Glycol Monobutyl Ether (CAS#111-76-2), Isopropyl Alcohol (CAS#67-63-0).

Green Chem Laboratories • www.GreenChemLabs.com • 1-800-964-3151

ERASE GRAFFITI WIPES

REMOVE GRAFFITI AND
LIGHT ADHESIVES



REMOVES
SPRAY PAINT



REMOVES
SHARPIE MARKER



REMOVES
LIGHT ADHESIVES



WON'T REMOVE
BACKGROUND PAINT



FAST
ACTING

ERASE GRAFFITI WIPES are a powerful graffiti and light adhesive remover. These towels are designed to easily remove paint, sharpie, adhesives, ink, scuff marks, and tar off of surfaces without removing background paint. Surfaces include: painted surfaces, signs, glass, plastic, wood, glass, and more. Featuring two sides, one soft and one abrasive, the towels use next generation cleaners to safely remove paints and sealants without redepositing contaminants. These wipes can be used both outside and indoors as they are virtually odorless.

DIRECTIONS FOR DISPENSING

1. Remove lid by lifting upward,
2. Pull towel from center of the roll and thread through "X" on the underside of the lid,
3. Close lid. Pull towel at 90° angle,
4. Snap hinged cap back into place to ensure towels stay moist.

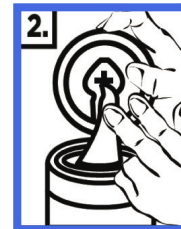
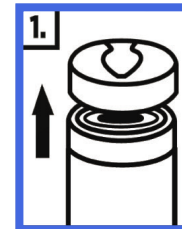

70 COUNT

9" X 12" HEAVY-DUTY, TWO-SIDED WIPES